

SITE PLAN SHOWING AREA OF PROPOSED RESIDENTIAL-CUM-COMMERCIAL APARTMENT OF 1) SRI ANANDA GOPAL MAITY S/O LATE ANIL KUMAR MAITY & 2) SMT. SWETA APL (AMITY) W/O SRI ANANDA GOPAL MAITY OF RABINDRANAGAR, P.O. & P.S.- MIDNAPORE, DIST.- PASHCHIM MEDINIPUR, ON R.S. & L.R. PLOT NO.- 321 (P), MOUZA - KERANITOLA, J.L. NO.- 171, P.S.- MIDNAPORE, DIST.- PASHCHIM MEDINIPUR WITHIN WARD No.- 6 OF MIDNAPORE MUNICIPAL AREA.



Latitude : 22.422407°
Longitude : 87.318498°

AREA OF THE PLOT - 934.76 SQM SHOWN THUS - []

PROPOSED AREA OF CONSTRUCTION SHOWN THUS - [- - -]

MAXIMUM PERMISSIBLE AREA OF CONSTRUCTION - 373.90 SQM. (40 % OF PLOT AREA)

PROPOSED HEIGHT OF THE BUILDING - 20.00 M.

SCALE - 1 : 350

ALL DIMENSION ARE IN METRE

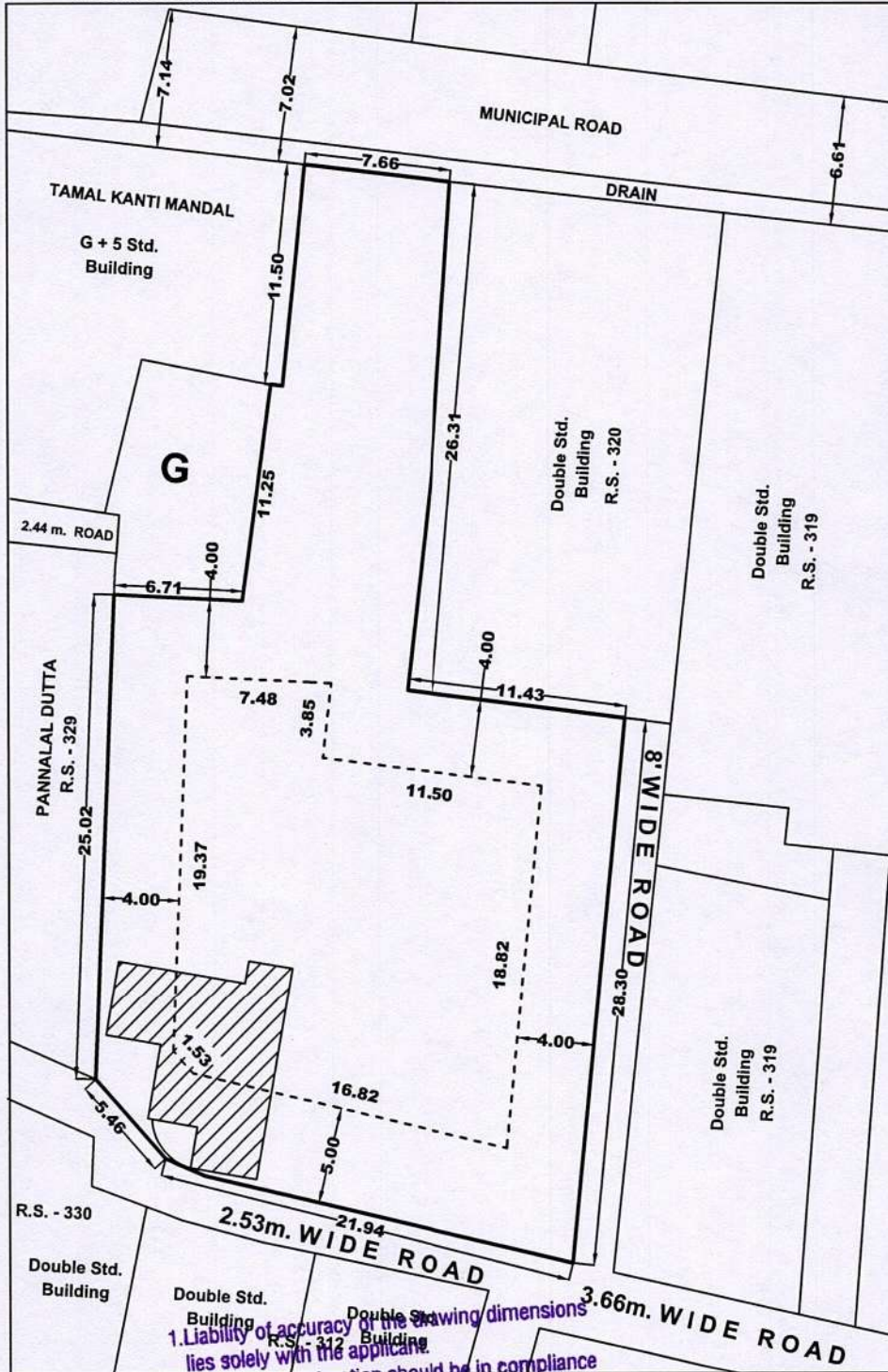

EXISTING BUILDING TO BE DEMOLISHED SHOWN THUS - [//]

1. Liability of accuracy of the drawing dimensions lies solely with the applicant.
2. Proposed construction should be in compliance with the existent Building Bye Laws.

DRAWN BY

Rohan Roy
ROHAN ROY
B.Tech, Civil Engineer
Regn. No. - 142750110074
Ph. 62941 / 5462 / 98312 32604

[Signature]
SURVEYOR
Midnapore Kharagpur Development Authority

[Signature]
Sweta Pal (Maity)
OWNER'S SIGNATURE